



5-1-23

BROOM SHEET

SUPER DEALS!

20% - 80% OFF!

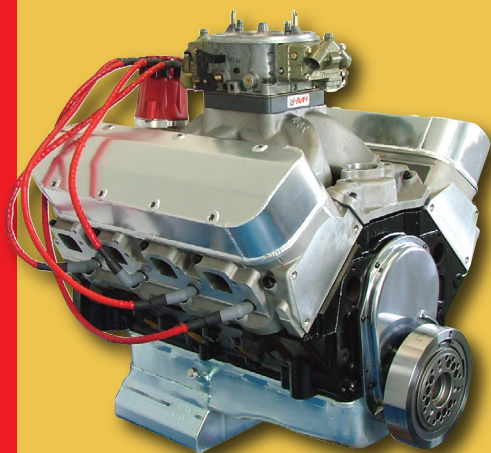

TOLL FREE 1.800.233.0199

ALL BROOM ITEMS SALES FINAL

NO HANDLING CHARGES!



FREE SHIPPING

orders over \$150.00



**Brodix Heads can be returned for a full refund for any reason within 14 days, no exceptions. All sales are final 14 days after date of invoice. Return shipping is the responsibility of the customer.*

CYLINDER HEADS *FREE SHIPPING & No Handling**

CALL FOR MORE INFO

14 day satisfaction guarantee

BIG BLOCK CHEV

BB-2 305cc,119cc jobber \$721.52	\$300.00 -400.00
BB-2plus 312cc,119cc.....	\$ 50.00 -650.00
BB-2 EXTRA 365cc,119cc jobber \$721.52.....	\$75.00 -500.00
BB-2 EXTRACNC 355cc,119cc (needs porting) jobber	
BPBB-2XTRA 355cc,119cc jobber \$1580.44	\$721.52 -\$250.00-600.00
BB-2PLUSPEC 312cc,119cc jobber \$721.52.....	\$250.00 - 400.00
BB-3XTRA18 363cc,119cc row jobber \$1059.27.....	550.00
BB-3XTRAO 335cc,119cc jobber \$1059.27	\$50.00 -600.00
BB-3XTRAO CNC 332cc,119cc (needs porting) jobber \$1059.27.	
.....	\$50.00 -400.00
BB-3Xtra 345cc,119cc	jobber \$1059.27 \$50.00 -450.00
BB-3XTRACNC 366cc,119cc (needs porting)jobber \$1059.27	
.....	50.00 -350.00
BPBB-3XTRA 366cc,119cc jobber \$1573.65	\$150 -500.00
BPBB-3XTRA CNC 366cc,119cc (needs porting)jobber \$1573.65	\$500.00
BB-4 390cc, 119cc,.....	jobber \$897.94 \$50.00 -400.00

FORD

T-1Ford(SB) 195cc. 68cc jobber \$516.78.....	\$150.00 -275.00
T-1FCNC(SB)(needs porting) jobber \$516.75.....	\$50 -500.00
T-1FX(SB) 195cc, 68cc jobber \$516.75.....	\$50 -500.00

SMALL BLOCK CHEV

T-1 STD 221cc,67cc jobber \$538.....	\$125.00 -350.00
T-1 STD CNC 221cc,67cc (semi finished)CNC casting	
jobber \$538.....	\$75.00 -500.00
11SPXseries 225cc,67cc jobber \$772.59.....	\$200.00 -350.00
KC11SPX 225cc,67cc jobber \$1247.20.....	\$450.00 -650.00
12SPP 247cc,60,68cc jobber \$985.19.....	\$250.00 -750.00
AK270 270cc,52cc jobber \$700.20.....	\$400.00 -500.00
SPCH 215cc,67cc jobber \$516.25.....	\$100.00 -350.00
SPEC CHEVY 170cc,67cc jobber \$516.25.....	\$250.00 -275.00
SPST 170cc,67cc jobber \$419.13.....	\$125.00 -250.00
46-221IMCA 215cc,some cnc jobber \$660.00	\$100.00 -325.00

150 HEADS

NEW 1sts! NEW Blems!

NEW Semi Finished
ALL HEADS NEW

40%- 90% OFF!



FREE SHIPPING &
No Handling*

Only 150 left from over 1,500 heads... going fast!



A

	WAS	NOW
Aluminum Radiator..CPXNTH 209659B , 22"x 21-1/2" - 3 3/4" wide radiator and kit (Northern Custom Kit)	359.95	195.00
Assembly lube.....CPXMSALUBE...MSA, Rod Bolt & engine Assembly Lube, .25 oz. aerospace	2.98	ea..99
Assembly lube.....CPXMSALUBE...MSA, Rod Bolt & engine 50 pack, .25 oz. aerospace., @50 pcs	2.98	ea..79



TRICK NEW RACE BEARINGS (SBC)



For any SB Chev, or LS, 2.100" rod. Use in both engines with fractured caps or any split cap rod. No need to remove the bolts or capscrews to rebuild. Just torque and hone to +.002. To 600 horsepower.

Tri-Metal Race Bearings for rebuilding SB Chev and LS rods. Bore +.002 . Crank journal available in std. or +.001, hi-load, high horsepower material, chamfered for large radii.

B663HOS2-STD.....79.95 Set B663HXOS2-STD(+.001 clearance).....79.95 Set

B

BEARINGS (SB CHEV)

CPXB429H001.....ACL Race series, large radius , small journal SBC main set -.001.....	79.99	59.95..
CPX4926MA30.....Sealed Power, SBC, .030 main bearing	99.99	59.95
CPXKEBMB5183Si.....350 Chev .010 mains , King.....	40.99	23.95
CPXCEPCB663HNK.....SB L/J rod, Tri-armor coated , Clevite .001.....	145.99	115.99
CPXCEPCB1776P-40...SB Chev Clevite Rods w/housing bore +.002 also LS1	24.95	14.95
CPXCEPMS-1038HK Clevite, SBC, 400 mains , new but opened., TRI ARMOR, Coated, Std.....	132.95	87.00

BEARINGS (FORD)

CPXBC306J..... main bearings, 351W , STD. open box, good set , EngineTech.....	27.99	14.95
CPXBB608J-030EngineTech Ford 351 W .030 , Set , rod bearings.....	21.99	11.95
CPX87160CH10.....SpeedPro Comp. Race, 289, 302 , 5.0L rod, -010	64.99	56.98

BEARINGS (BB CHEV)

CPXACLSM829A-030...ACL mains, .030 , Street series, NEW but opened.....	29.99	18.00
CPXCEPM5829MV.....Clevite mains, std. or .020 , scratches, very useable.....	52.99	26.49
CPXSEA7388MA.....Chev Mains, STD., 8.1 litre, sealed power	114.99	84.95

BEARINGS (CHRYSLER)

CPXCEPMS1795V....Clevite, STD. Chrys. 440 Mains, Street Series, opened box, NEW, V-series	125.99	80.00
---	--------	-------

Main Bearing SPACER CPXSEA147M-SEMi SB Ford, STD. 351C, in SB Ford , Sealed Power.....	119.99	83.99
CAM BEARINGS CPX5C290S-00E SB Chev. SPECIAL BUY, 1/2 OFF! ACL.....	24.95	9.95
Bat. Terminal Disconnect CPXMOR74103 Moroso Top Post Bat. w/ switch.....	27.99	19.99
Balancer Bolt CPXARP154-2501 , ARP Ford 351C kit.....	21.99	18.99

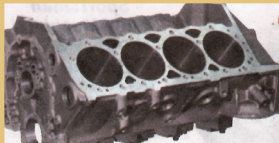

BIG SAVINGS!

DART RACING BLOCKS

Minor Seconds



DRX31162212 SHP Pro blk,SBC 9.025 4.125 400M BBC cam .904 lifter, Timing cover hole issue.....	\$2,235.95
DRX31213455 BBC Iron 10.200 deck 4.500 billet main, raised cam, 55mm babbitt, .904 liter.....	\$3,199.95





HOWARDS CAMS



WAS NOW

CHEV 348-409

CPX139991.....Hyd. F/T, 496/496 lift, , 221/221@ .050, 112 L.C,260.00 **140.00**

BB CHEV HYD. ROLLER

BBCHR496MAG.....BBC 8.1L "C" firing order, Hyd. Roller, 481/481, 205/209@.050, 117 L/C Gen 6.....349.95 **209.95**
 BBCHR496HO.....BBC 8.1L "C" firing order, Hyd. Roller, 519/510, 225/233@.050, 115 L/C Gen 6.....349.95 **209.95**
 CPX HRC 129996-A..BBC Hyd. Roller, 658/657, 244/254, @.050, 114 L/C349.95 **274.95**
 CCA11-000-14.....BB Chev Hyd.Roller Competition cam, custom 647/647 lift, 258/262 @.050, 114 L.C.,456.95 **389.95**

LS

CPX192005-12A.....Hyd. Roller, 525/525 lift 214/220@ .050, 112 L.C. .3 bolt., (base cir. is slightly undersize),359.95 **259.95**
 CPX199996B.....Hyd. Roller, 588/604 lift, 228/238 @ .050, 109+4 L.C , 3 bolt.....399.00 **299.95**
 CPX199996A.....Hyd. Roller, 604/604 lift, 230/236 @ .050, 113+4 L.C , single bolt.....339.00 **259.00**
 CPX199995F.....Hyd.Roller, 629/641 lift, 207/213 @.050,112+4 L.C. 3 bolt.....359.95 **259.95**

Pontiac

CPX419991A..... Hyd. F/T, 490/490lift, , 233/233 @ .050, 111+4 L.C, nick in journal.....179.95 **159.95**

LATE HEMI

CPX789995.....HEMi Gen 3, 520/595, 215/226 @ .050, 116 L.C,487.95 **299.95**

Chrysler B/RB

CPXHE300JK3-0.....MECH F/T 3-bolt, 435/435, 230/230 @.050, 113 L.C, low end power.....249.00 **129.00**

Ford 351W

CPX222021-10...Hyd. F/T 543/563 lift, 220/226 @.050, 116 L.C.....129.95 **104.95**

FORD 429-460 BB

CPXHRC249993 Mech Roller 779/744 lift, 293/291@.050, 112 L.Custom.....1420.00 **275.95**

SPECIAL! Elgin Cam Sale...420/443, 204/214@ .050, 112 LC., SB Chev, HYD. F/T
 CAM ELGE-923-P...71.95 Cam & Lifters , ELGE - 923-PM..... **136.95**

C

WAS NOW

Coil Wire Kit CPXMOR73235 MOROSO, ultra 4.0 race set, sleeved, strt boots , 8.65 mm..... \$235.95 **186.00**
Crankshaft Pulley CPXMOR64201 Moroso billet V belt, 1 groove, BBC short pump..... \$96.99 **69.99**
Chromoly Washers CPXARP200- 8554, ARP special purpose , .375 ID, 120 thick, pk. of 10..... \$8.99 **5.99**
Cylinder Head Bolts CPXARP135- 3604, ARP BBC Cast iron head w/ washers..... \$94.99 **79.99**
Cylinder Head Studs CPXARP234- 4103, ARP Pro Series, SBC , Brodix - 12/18 kit.....\$222.99 **175.00**
Connecting Rod Bolts CPXARP 154- 6402, ARP Wave Loc ,FORD, 289, 302..... \$79.99 **59.99**

C



SALE!

CLP PERFORMANCE **CAST STEEL CRANKSHAFTS**

Superior cast steel material for durability. Stronger than O.E.M. castings. Micro polished, stress relieved and shot peened. Uses stock style bearings.

\$309.95/319.95 **FREE FREIGHT!** **SUPER DEAL!**

Chev BB (1 pc. Rear Main)

CLPQT-502.....454 Main, 4.000" Stroke, 6.135-up Rod, External balance.....	309.95
CLPQT-502B.....454 Main, 4.250" Stroke, 6.385-up Rod, External balance.....	319.95



WAS NOW

Deals On Cranks

CPXCLSCSA6113-CM. SBC Callies, Compstar 350M, 2.100 J, 3.562.stroke.....	\$830.00	674.95
CPXCLPQT-502B..BBC cast steel, 4.250S, 6.385R, ext. bal., 1 pc. rear, small nick in 1 &2 rod.....	\$289.95	319.95
CPXH454256321T. BBC, Howards 4340, T Smart, 4.25S, 6.385 R, 1 pc. rear, small nick in front main.....	\$929.95	329.95
CPXEAG4350335057LA SBC, 4340 forged, lightweight , 3.350S, 2.100J , 2 pc.,.....	\$895.97	595.99

D

Degree Wheel Bolt CPXJOM7051, SB Chev, Fits most wheels includes bushing.....	\$4.99	2.99
Dial Bore Gauge CPXPFM67411, Professional Kit, from 2"+ 6" bore.....	\$159.95	137.95
Distributor CPXETPE3- 412, Ford 5.0L SFI, Diamond Fire, w/ remote module.....	\$259.95	159.95
Distributor CPXPVT 25-5301, Power Products, Chrysler 426-440 Billet ready to run. Bad reluctor wheel.....	\$179.99	99.00
Distributor CPXPVT 25-3935, Power Products, HEI Chev, Pro Black, SB/BB Chev.....	\$109.95	89.95

E

Engine Programmer...CPX20093-1...Ram 2500 truck, 6.7 diesel, 6 driving modes, 2014-UP.....	245.00	\$139.00
Electric Water Pump..CPXMOR63595..Moroso billet, OEM mount, FORD 429/460.....	\$535.99	399.00

F

Fuel Filter.....CPXSYS 202-202412B, Billet , AN-12, 2"OD, 9" long,, system 1.....	200.00	\$137.00
Fitting...CPXSYS202 - 202412B Fragola Hose End, 90 degree, male, 3/4 NPT red, blue, 2" O.D.....	29.99	\$22.99
Flexplate Bolts. CPXARP100-2901, ARP, Chev/ Ford Set 7/16- 20.....	12.99	\$9.99
Fuel Pump CPXAER11151 Aeromotive platinum electric up to 1500 HP., A1000 Submersible.....	459.99	\$409.99
Flexplate Shield..CPXTWP600 SFi, Chev powerglide, TH350-400 TRWCP Powder Coated.....	75.99	\$64.99
Flexplate Shield..CPXTWP606 SFi, Ford FE, TRWCP Powder Coated.....	89.99	\$69.99
Fuel Filter Screen..CPXMOR97062 Moroso, for 65230, 65231 filters.....	20.99	\$9.99
Fuel Pressure Gauge.. CPXAUT5761, autometer phantom elect analog	296.99	\$239.99
Fuel Gauge.. CPXAUT5716, autometer phantom elect	79.99	\$59.99

SFI FLEXPLATES \$65.99 to \$67.99



FORD WOW!

CLP PERFORMANCE **SFI Approved Flexplates**

Lightweight design. Constructed from high tensile strength ,extra thick material. Double welded ring gears designed to withstand high torque startsrs. Meets SFI spec. 29.1.

CLPFP-302N...Ford 289-351W, 164T, Int.Bal. 67.99	CLPFP-460Ford 429-460 164T, Ext.Bal. 65.99
CLPFP-302EFord 289-351W, 164T. 28 oz. Ext.Bal. 65.99	CLPFP-460A....Ford 429-460 164T , Int.Bal. 67.99

G



GASKETS
MR. GASKET ITEMS
From 60% to 80 % OFF!

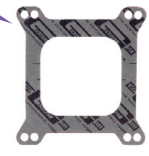

WAS NOW

CPXMRG1204	Collector Gasket. 3 Bolt, 3.0"each	6.46	2.99
CPXMRG5971	Collector Gaskets, Ultra-Seal ,Steel Core , Laminate, 3" diam.....	pair	12.96	5.99
CPXMRG5980	Collector Gaskets, Ultra-Seal ,Steel Core , Laminate, 2.5" diam.....	pair	14.04	5.49
CPXMRG7176C.....	Collector Gaskets, Copper-Seal , 3-Hole , 2.5"inside diam.....	pair	18.36	7.99
CPXMRG7177C.....	Collector Gaskets,Copper-Seal , 3-Hole , 3.0"inside diam.....	pair	18.36	7.99
CPXMRG7420G	Collector Gasket , Soft Aluminum, 2.50" Dia., 3 bolt holes w/bolts.....	pair	16.11	5.95
CPXMRG150B.....	Exhaust Gasket, Small Block Chev , Round port, 1.50 dia.....	pair	14.04	7.47
CPXMRG5900	Exhaust Gasket, Ultra-Seal Core Laminate, Sq. port, Chev Small Block, 1.45 x 1.48...pair		21.61	7.95
CPXMRG5902	Exhaust Gasket, Ultra-Seal Core Laminate, Round port, Chev Small Block, 1.63" dia..pair		21.61	7.95
CPXMRG7401G	Exhaust Gaskets, Soft Alumi, 1.55" x 1.45" Port, Chev Small Block. , 1.45 x 1.48.....	pair	26.47	10.95
CPXMRG7402G	Exhaust Gaskets, Soft Alumi, Large Round Port, Chev Small Block. 1.63" dia.....	pair	26.47	10.95
CPXMRG150	Exhaust Gasket, Hi Temp , round port, SB Chev , (2 pr. 4.99 ea.).....	pair	12.95	6.47
CPXMRG3413	Header Collector Bolt Kit, 3/8-16, 1.0" long , 3- pieces.....		3.45	2.49
CPXMRG9753.....	Wire Loom, 4-dividers, tall, style chrome, pair.....	pair	5.95	2.99
CPXSCEP36156.....	Head Gasket Ford SB , 4.155 bore, .062 SCE copper, 1 pr.....	pair	164.95	124.95
CPXSCE36064.....	Head Gasket Ford SB , Titan copper, .043 , 4.060 bore, SCE , 1 pr.....	pair	280.00	175.00
CPXFEL1041	Head Gasket LS Fel-PRO head, 4.135 bore, 97-03 LS-1, .041, one pair.....		168.00	83.95
Gauge	CCGAUGE.....Crankcase Vacuum/Pressure tester gauge.....		28.25	7.00

DUAL IDLER Gear Drives

..... These precision gear drives feature CNC machined components and heat treated durability. They offer high precision timing and eliminate chain stretch. The heavy duty dual idlers are designed for accuracy> These drives fit under your stock timing cover. Easy to install. Note:m Minor machining for thrust washer may be required. **Up To 1/2 Off!**

CLPTG-350N.... SB, Noisy **99.95** CLPTG-302...FORD SB,260, 289,302,.....**69.95**

H

WAS NOW

Harmonic Balancer. CPXPBDBP1018ST	BB Chev, street, 8" External, hole + .001.....	137.99	99.95
Head CPXBRO1118000.....	SB Chev Brodix.-11X, 23°, spread port ex. 231cc, 67cc, for 2.100/1.6 valves, alum. angle plug, full CNC'd, bare pr.....		2494.40	1899.00
Head CPXPVT54406.....	BB Chev Alum. 310 cc, rec. port, fixable crack in valve cover area., 1 pc.....		\$450.00	250.00
Head LS-1.....	Chev LS Alum. cathedral port, 6-bolt, 64cc., new sample.....		398.00	198.00
Head CPX5303-1B.....	World Windsr Jr, 180 cc, 58cc, 1.94/1.6, bare , small crack in valve cover area, 1 pc.....		490.54	250.00
Head CPXDRT15100010.....	Dart BBC Iron Eagle, rect. port, 308 cc, 2.250/1.88 one head.....		\$847.00	747.00
Head CPXRHS54501.....	RHS LS7 Pro Elite, CNC ported, 291/69cc, angle plug , bare, 1 pair.....		2878.00	2298.00
Header Stud Kit CPXARP100-1404.....	ARP12 pt. , Ford , Chev V-8, custom 450 materials, studs, nuts, washers.....	set of 16...	\$83.97	63.97
Intake CPXTSP82026.....	SB Chev , TSP, air gap, dual plane (small leak at front		217.95	139.95
Intake manifold bolts, CPX4652	zinc 6 pt. kit, SB Chev & SB Chrys, hex head set		14.95	7.99
Ignition Box CPXTAY401000...	Taylor Vertex Z6 w/ Rev limiter.....		265.99	224.99

ALL SALES FINAL!

LIFTERS

L

WAS NOW

Mech. F/T CPX91718B...Chrys.383 - 400, 392-426 Hemi, direct lube, EDM , appearance blem	SET.....	329.95	249.95
Mech. F/T CPX91715B...Chrys. SB, BB, Hemi, , appearance blem	SET ...	289.95	229.95
Hyd. F/T CPX91711-B.....AMC/CHRYSLER, 273-440 [appearance blem] Howards.....	SET.....		64.00
Hyd. F/T QLC36.- 817-16.....Chev V-8, performance lifters [while they last] Set.....		89.95	65.99
Hyd. F/T Flat Tappet CPXSRP4214VDL-1..Ford SB, 429, 460, variable duration, 14 pieces.....			5.00 ea.
Hyd. F/T CPX91212B..Ford , 221 -351W, Max effort, appearance blem	SET	219.95	174.95
Mech. F/T CPX91125B...GM 6 cyl. 235-261, slight blems 1/2 off.....	SET	365.95	182.50
Mech. F/T CPXHRC91125B...GM 6 cyl. 235-261,	SET	329.95	149.00
Roller..CPX911065.....SBC Hyd. Roller, Howards Max Effort, Stock Blocks Only.....		559.95	489.95
Roller..CPX91165.....BBC Hyd. Roller, Howards Max Effort, Stock Blocks Only.....		559.95	489.95
Roller..CPXSRP3316BBR.....B/B Chrysler, mech. roller, retro tie bar.....	SET		350.00
Roller..CPXSRP3316SBR.....S/B Chrysler, mech. roller retro tie bar.....	SET		340.00
Roller..CPXSRP2116LS-1.....LS Chev. retro tie bar, pairs for 7 cyl.....			30.00 ea.cyl.
Roller .CPX91466A.....Pontiac hyd. roller, street, tiebar, dyno time only , Howards.....	SET	542.29	299.95
Roller..CPXPVT8099-1.....BB Chev, Mech. roller, + .300 tall, 7pair +.002 body.....	EA..PR...	45.00	25.00
Roller..CPX91254.....Ford FE, 429-460, mech., Howards S/S to 450 Lb., springs.....		415.95	315.95
Roller..CPXHRC91167D.....BBC, Hyd. Street Series, to 6500 RPM, dyno run 1/2 OFF! Howards.....		579.95	289.00
Roller..CPXHRC91169D.....Ford 426-460 FE Hyd. Street Series, to 6500 RPM, dyno run, 1/2 off, retro tie bar.....		579.95	289.00
Roller..CPXHRC91250.....Ford SB 221-302, 351C, M, 400 Street Max, Mech. Roller		463.95	379.95
Lube..CPXMSALUBE.....Rod bolt & Engine Assy. Lube, 25 oz. aerospace quality, 50 pack.....		149.50	39.50
Lube..CPXMSALUBE.....Rod bolt & Engine Assy. Lube, 25 oz. aerospace quality each.....		2.98	.99

M

Main Cap Strap.....CPXH350RSDS.....Howards Dry Sump, Chev SB 350., (fits rear caps).....		31.95	11.00
Mufflers.....CPXFLO943051.....Flomaster 50 Series, 3" in - out, { One pair}.....		139.95	99.95

TWRCP Front Motor Plates

1/4" Thick, 6060-T6 36" W



TWRCP Mid Mount Plates

30" W STEEL .090

	WAS	NOW		WAS	NOW
CPXTWP700 ChevSB	135.95	116.95	CPXTWP2003 Ford 289 - 302, 351W, C	92.95	72.95
CPXTWP701 ChevBB.....	135.95	116.95			
CPXTWP710 ChevBB profiled ..	169.95	146.95	CPXTWP2004 Ford 351M,400,		
CPXTWP711 ChevSB profiled	169.95	146.95	426-460.....	92.95	72.95
CPXTWP708 Ford 429-460....	149.95	119.95	CPXTWP2005 Chev V-8,V-6 ...	69.95	59.95

N

WAS NOW

NOS Heater.....CPXNOS1416NOS....Bottle Heater , 10/15LB., thermostatic controlled open box.....		234.95	189.95
Nitrous Pressure Gauge....CPXAUT3328...Autometer sport comp, 0-2000 psi, mech.		129.99	99.97

O

Oil Pan .CPXMOR20413 Moroso BBC V, VI , 1 pc., 6 Qt. , S/strip		376.99	289.00
Oil Pan .CPXPVT-21-8251 SBChav, IMCA , 5 quart.....		125.95	95.00
Oil Pan Kit..CPXMiL31920 Milodon Ford 302 front sump, Pan pickup, gaskets, bolts, tray, studs, shaft.....		480.95	380.95
Oil Pan Kit..CPXMiL31900 Milodon SBC, 7 quart, w/tray, pickup gasket, bolts.....		484.95	384.95
Oil Filter.....CPXJOM9010 Jomar Pro, Hi-Flow, no bypass, 600 PSI, Chev.		14.99	9.99
Oil Pump Pickup...CPXCVRPU7782.. CVR BBC for 8.25" deep pan		49.95	29.99
Oil Filter Element...CPXSYS208-882..system 1 filter, billet 8" x 5-3/4".....		92.00	42.00
Oil Pressure Warning Light Switch CPXMOR97015, Moroso 1/8" NPT, 15 Psi on, 50 Psi off.....		59.99	44.95



.110" Thick-Wall 210 degree Tip 5/16" Pushrods

.110" wall thickness offers more strength and increased stiffness. Manufactured from 4130 aircraft quality material. Hardened & black oxide coated for superior strength & durability. Centerless ground and hard turned,.1565" x .210" radius ends. Guide plate compatible.

PRICED AS EACH

ELGPR15625...5/16", 6.250", each...\$7.99	ELGPR15785...5/16", 7.850", each...\$7.99
ELGPR15635...5/16", 6.350", each...\$7.99	ELGPR15790...5/16", 7.900", each...\$7.99
ELGPR15660...5/16", 6.200", each...\$7.99	ELGPR15795...5/16", 7.950", each...\$7.99
ELGPR15680...5/16", 6.800", each...\$7.99	ELGPR15800...5/16", 8.00", each...\$7.99
ELGPR15685...5/16", 6.850", each...\$7.99	ELGPR15805...5/16", 8.050", each...\$7.99
ELGPR15690...5/16", 6.900", each...\$7.99	ELGPR15810...5/16", 8.100", each...\$7.99
ELGPR15695...5/16", 6.950", each...\$7.99	ELGPR15815...5/16", 8.150", each...\$7.99
ELGPR15700...5/16", 7.000", each...\$7.99	ELGPR15820...5/16", 8.200", each...\$7.99
ELGPR15715...5/16", 7.150", each...\$7.99	ELGPR15830...5/16", 8.300", each...\$7.99
ELGPR15720...5/16", 7.200", each...\$7.99	ELGPR15835...5/16", 8.350", each...\$7.99
ELGPR15730...5/16", 7.300", each...\$7.99	ELGPR15840...5/16", 8.400", each...\$7.99
ELGPR15735...5/16", 7.350", each...\$7.99	ELGPR15845...5/16", 8.450", each...\$7.99
ELGPR15740...5/16", 7.400", each...\$7.99	ELGPR15855...5/16", 8.550", each...\$7.99
ELGPR15745...5/16", 7.450", each...\$7.99	ELGPR15865...5/16", 8.650", each...\$7.99
ELGPR15770...5/16", 7.000", each...\$7.99	ELGPR15870...5/16", 8.700", each...\$7.99
ELGPR15635...5/16", 6.250", each...\$7.99	ELGPR15875...5/16", 8.750", each...\$7.99
ELGPR15775...5/16", 7.750", each...\$7.99	ELGPR15880...5/16", 8.800", each...\$7.99
ELGPR15780...5/16", 7.800", each...\$7.99	



.137" THICK-WALL 210" tip 3/8" pushrods

Unsurpassed strength & durability. .137" wall thickness offers up to 40% greater column strength and increased stiffness. Made from 4130 aircraft quality seamless chrome moly.Centerless ground & hand tuned..1565x210" radius ends. Through hardened & black oxide coated for superior strength. Guide plate compatible.

ELGPR-13790...5/16", 6.250", each...\$9.95
ELGPR13795...5/16", 6.250", each...\$9.95
ELGPR13810...5/16", 6.250", each...\$9.95
ELGPR13830...5/16", 6.250", each...\$9.95
ELGPR13835...5/16", 6.250", each...\$9.95
ELGPR13840...5/16", 6.250", each...\$9.95
ELGPR13845...5/16", 6.250", each...\$9.95
ELGPR13850...5/16", 6.250", each...\$9.95
ELGPR13855...5/16", 6.250", each...\$9.95
ELGPR13860...5/16", 6.250", each...\$9.95
ELGPR13870...5/16", 6.250", each...\$9.95
ELGPR13880...5/16", 6.250", each...\$9.95
ELGPR13925...5/16", 6.250", each...\$9.95
ELGPR13930...5/16", 6.250", each...\$9.95

FORGED PISTON DEALS!



	WAS	NOW
CPXENGP5016.....SBC Std. 4.0 bore, 350, 5.7 R, F/T, Engine Tech, Hyperutectic.....	149.95	99.95
CPX207421.....Chrysler SB, JE 4.070 bore, F/T, 4.00 stroke, 6.125 rod,11.6 CR, C.H., 1.460.....	863.12	649.00.
CPXWISK472X25.....HEMI 4.080 bore , 3.580S, 6.243R, 6.7CR, Turbo, 1.5, 3.0 MM, 2618 Material. Wiseco.....	859.00	527.00
CPXWISAW-05477LS Chev 4.165 bore , 4.125S, 6.125R, 13.5 CR, 1.2, 1.2, 3.0 MM lands, 2618 Material. Wiseco.....	864.99	562.00
CPX170667.....BBC, JE 4.530 bore, Big Duke /Chief , 4.250S ,6.535, .043, 1/16, 3/16, 18°gas ported, C.H.1.120, 14.3 CR/87 CC..1021.95	1021.95	675.00
CPXiC861-80.....FORD 520 Ci Dish Icon, 4.440 B, 4.5S, 6.800R, 2618 mat.....	892.99	575.00
CPXiC981-30.....PONTIAC 4.155B, 4.25S, 6.635R, Dish CH 1.465, 2618 mat.....	730.99	539.95
CPXSRP271108.....Ford 4.6/5. 4 Litre mod., SRP spherical dish, 3.572B 3.543S, 5.933R, w/ith Plasma moly rings.....	913.16	679.00
CPXJEP258244.....BB CHEV , 498 4.320B, 4.250S, 6.385R, 2618,13-1.....	1050.00	798.00
CPXJE258202.....BB CHEV Nitrous 4.610 B, 4.250/4.375 S, 6.385/6.70R, 2618, gas ported 14.7 cr.....	1217.00	954.95
CPXWISK472X25.....LATE HEMI 4.080B, 3.58S, 6.243R, 8.7 CR., 2618, w/rings, Wisco.....	859.00	527.00
CPXWISAW-05477.....LS CHEV 4.165B , 4.125S, 6.125R, 8.7 CR, 2618, w/rings, Wisco.....	879.00	562.00
CPXHRC4586.....BB CHEV 4.50 B, 4.250S, 6.385R , 2618 Howards., 13.7/118cc.....	699.95	599.95
CPXMAHSBC425030FO5..SBC, Mahle pistons & rings, 4.030B, 3.75S, 5.7R, F/T 11.3 CR., forged, includes MM rings.....	621.00	519.95

PUSHRODS

CPXPVT847.....Ford 351W, 8.150, C1010, guideplate ,OK 5/16 "	36.95	24.95
CPXMAN25768-16.....Manley 4130 Moly, swedged end, 5/16 7.650 "	214.41	92.00
CPXMAN25920-8.....Manley 4130 Moly, swedged end, 3/8 X, 9.200, .080 wall, 8 pcs	89.95	64.95
CPXMAN25832-8.....Manley 4130 Moly, swedged end, 3/8 X, 7.750,, .050 wall, 8 pcs	89.95	64.95

R

Howards Billet Rods **1/2 OFF!**



ARP 2000 Capscrew upgrade American Made!

					WAS	NOW
Dodge Neon SRT 5.945	Billet	X Beam, 7/16 ARP 2000, 22 mmp, firsts	BX5945SRT	873.99	873.99	436.84
Mitsubishi 4G63 5.900	Billet	7/16 ARP 2000 22mmp. firsts	PR59001771	873.69	873.69	436.84
Mitsubishi EVO 6.136	Billet	7/16 ARP 2000 4G63 22mmp. late	PR6136177E	873.69	873.69	436.84
Nissan RB30 6.001	Billet	7/16 ARP 2000 21 mm pin, 6 cyl. balanced	BR6001RB30WM	995.00	995.00	499.50
Nissan RB30 6.001	Billet	7/16 ARP 2000 , 21 mm pin, 6 cyl. firsts	BR6001RB30	995.00	995.00	524.95
5.7 HEMI 6.250	Billet	7/16 ARP 2000 , .937 pin, needs balancing	CPXBR6251HEMI	999.95	999.95	499.50



DURAMAX BILLET RODS **30% OFF!** 2000+ H.P HOWARDS RODS- American Made

Howards RodsCPXBX6420... GM Duramax 6.6 LX Beam Billet rods. Ultimate strength and weight. EDM lasered hole from rod bearing journal to wrist pin. 7/16" ARP 2000 capscrews, extreme duty turbo or supercharger applications. No better Duramax rod madeSET 2899.00 ~~1995.00~~

30-35% OFF!

PEP BILLET I-BEAM RODS Limited Quantities - ARP2000 7/16 Capscrews, bushed



SB Ford, 5.933, CPXCBC-5933-i...\$699.95 ~~479.00~~ BB Chev, 6.800, CPXCBC-6800-i... \$799.95 ~~489.00~~

SUPER DEAL!

Rods.....CPXSBC60.....SB Chev. 6.0" forged racing rods, bushed, 3/8 capscrews, I-beam, 600 grams seconds, not QC'd, needs QCing, possible big end rehone, etc. Priced for cost of capscrews, not returnableSET of 8 ~~78.00~~



PRECISION DENSE FORGED I-BEAM RODS

ASTM 4260 Super Stee Material
6% More Yeild Strength & 10%
More Ultimate Tensile Strength Over 4340
Up to 650 Horsepower
Proprietary Fracture Cap Technology
All Rods 100% Magnafluxed
ARP 2000Cap Screw Fasteners
585 Grams (Approx.)



Fractured Cap Technology

Fracture split surface eliminates fretting and offers superior alignment

Saw cut surface



Chev SB (LJ) with ARP 2000 Cap Screws (650 HP)PPF6000 6.000"(585g)\$516.95

Dense Forged Rod **with TRI-METAL Race Bearings**

Big end machined to + .002 O.D.
for matching +.002 O.D. Race Bearings.(included)

Bearings available in STD. or .001 Clearance ...to 500 H.P.



PPF6000AS
Reg, Assy. \$619.00
NOW \$399.00
Limited Time!

Super Pricing\$ RINGS Up to 1/2 Off!

ONE SET OF EACH ONLY!

BLOW OUT!

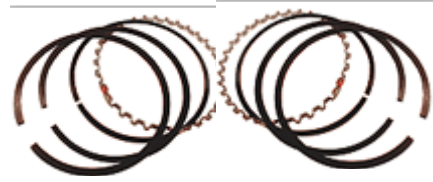

Listed by Bore Size

WAS NOW

SEALED POWER • SPEED PRO • JE • MAHLE • HASTINGS • GRANT

CPX2M5548.....3.736 bore, Hastings Moly 305 Chev. 5/64, 5/64, 3/16.....	129.95	59.95
CPXMAH3927MS-15.3.927 bore, Mahle 1.5, 1.5, 3.0 mm , drop in plasma moly, 1/2 OFF!.....	152.99	74.33
CPXMAH3947MS-15.3.947 bore, Mahle 1.5, 1.5, 3.0 mm , drop in plasma moly, 1/2 OFF!.....	152.99	74.33
CPXR9343005.....4.0+5 bore, Speed Pro, plasma moly, 5/64, 5/64, 3/16.....	154.99	125.00
CPX4000CD8.STD.....4.0 bore, Hastings , Moly , 1.5, 1.5, 3.0 mm ,	69.99	37.99
CPXR940105.....4.0 bore + .005, 1/16, 1/16, 3/16 plasma moly, 1/2 OFF!	139.95	69.95
CPXHASC5532.....4.0 bore, Hastings , claimer, 1/16, 1/16, 3/16 ,	59.95	39.00
CPXRC4000HS..... 4.0 bore, Grant race proven, 1/16, 3/16, 1/2 OFF!..for Hypereutectic pistons.....	139.95	69.95
CPXE180K30.....4.080 bore , Speed Pro 5/64,3/32, 3/16 ,moly.....	69.95	59.00
CPXR977110.....4.010 Bore, Speed Pro, Plasma Moly, File Fit, 1/16,1/16, 3/16.....	104.99	82.95
CPXR977110.....4.010 Bore, Speed Pro, Plasma Moly, File Fit, 1/16,1/16, 3/16.....	104.99	82.95
CPXCUSTOM- CR-08..4.040+5 bore, Total Seal, .031, 1/16 ,3/16, Race.....	287.30	149.95
CPXHASSN9045030..4.030 bore, Hastings LS , 1.2, 1.2, 3.0 mm, gas nitrated stainless steel.....	138.95	99.35
CPX4000CD8.040.....4.040 Bore, Grant , 1.5, 1.5, 3.0 mm, plasma moly, pre gapped.....	69.95	37.99
CPXTOTCRH201055 .4.050 + .005 Bore, Total Seal, Classic race, 1.5, 1.5, 3.0 mm, 1/2 OFF!.....	118.59	59.29
CPX4000CD8.060.....4.060 Bore, Grant , 1.5, 1.5, 3.0 mm, plasma moly, pre gapped.....	69.95	37.99
CPXRA4125HS..... 4.125 bore, Grant race proven, 5/64, 3/16 1/2 OFF! for Hypereutectic pistons.....	139.39	69.95
CPXRP4125B65.....4.125 +.065, Bore, Grant .1/16, 1/16, 1/8, race proven	112.95	69.99
CPXCP4125BSTD.....4.125 Bore, Grant .1/16, 1/16, 1/8, claim proven	79.95	69.95
CPXRP4125CS..... 4.125 bore, Grant race proven, file fit, 4.125 +.005, 1/16,1/16, 3/16.....	109.99	87.95
CPXE- 299X30.....4.150 bore, Cast, 5/64, 5/64, 3/16.....	52.95	26.95
CPXCA4125H40.....4.165 Bore, Grant claim proven, 5/64, 5/64, 3/16, for Hypereutectic pistons.....	73.00	49.95
CPXRA4125045..... 4.165+5 bore, Grant race proven, 5/64, 3/16 1/2 OFF!.....	139.39	69.95
CPXENGR41258-40...4.165" B,cast, Engine Tech, 5/64, 5/64, 3/16.....	33.95	23.95
CPXHAS2M683030...4.280 Bore, Hastings Ductile 5/64, 3/16, Plasma Moly,	49.95	36.95
PXTOTT269065.....4.420 + .005 Bore, Total Seal, TSI gapless, 1/16, 1/16, 3/8, 1/2 OFF!.....	258.67	129.33
CPXJEJ100F8-4500-5...4.500+5 bore, plasma Moly , 305 Chev. 1/16, 1/16, 3/16.....	251.78	129.95
CPXSTOT100874.....4.505 Bore, .017 Dykes Axial, top only	46.00	32.00
CPXSEAR20113-5.....4.500+.005 Bore, Speed Pro , .043, .043, 3.0 mm, plasma moly,	149.50	78.95
CPXMS4302285.....4.530+.005 bore, .043, 1/16, 3/16, AP gapless.....	375.96	189.95
CPXTOTCS2016.....4.560 Bore, Total Seal, 1.5, 1.5, 3.0 mm, classic steel race, new but opened,	325.00	200.00
CPXR1059560.....4.560 Bore, Speed Pro, 1/16, 1/16, 3/16, Plasma Moly, Race.....	147.99	69.95
CPXSEAR10595-60....4.560 Bore, Speed Pro ,1/16, 1/16, 3/16, plasma moly,	147.99	99.00
RING DEBURRING STONES...For end gap surface, Coarse & Fine, 1/2 Off!.....	7.50	3.75

BROKEN SETS AVAILABLE! - CALL!

Involved in a Car Show ? We can Help!.....920-230-4240

R

WAS NOW

RetainersCPXCCA754-16.....Comp Cams titanium 7°, Gen III, LS., dual spring, 1.250 O.D.....	236.95	189.95
Rods.....CPXSBC60.....SB Chev, forged 6.0, 600 grams, 3/8 capscrews, needs rehone, no return	Set of 8...	78.00
Rod CapscrewsCPXMSAMSP05005.....Aerospace. Pro Series, 245,000 PSI, 5/16" x1.450" (set of 16) 70% OFF!	138.00	41.40
Rod CapscrewsARP4AP1. 600-1 LU.....7/16, 1.60"U.H.L.....8740 ARP.....ea.....	6.99	4.99
Rod LubeCPXMSALUBE.....Aerospace rod bolt assm. lube , .25 oz.(50 Pack-.79¢ ea)....	2.93	.99
Remote Filter Adapter CPXMOR23703.....Moroso 90 degree - 10 AN- 10 - AN billet, Chev V-8.....	152.99.	99.00

Ring, Bearing & Gasket Kits

Perfect for freshening up that engine. These kits include parts you can trust! Designed for use with stock pistons but will work with many aftermarket applications. Includes 5/64", 5/64" 3/16" rings { others available upon request }. Please specify bore and bearing sizes. **NOTE: Not for applications with shallow oil ring grooves.**

CMPRBG283 ..Chev 283 60-67,3.736"-3.766"Bore.....	\$102.99
CMPRBG305 ..Chev 305/5.0L 76-85 (except FI) ,3.736"-3.766"Bore..	85.99
CMPRBG307 ..Chev 307 68-73,3.736"-3.766"Bore.....	95.99
CMPRBG327 ..Chev 302-327, 62-67,sm.journal, 2 pc. seal, 4.000"-4.080"Bore.....	102.99
CMPRBG350 ..Chev 302-350, 67-85,lg.journal, 2 pc. seal, 4.000"-4.080"Bore.....	84.99
CMPRBG350L ..Chev 350 86-89, 1-pc. seal, 4.000"-4.080"Bore.....	109.99
CMPRBG400 ..Chev SB 400 ,70-80, 4.125"-4.185"Bore.....	117.99
CMPRBG402 ..Chev BB 402 t0-73 4.125"-4.185"Bore.....	119.99
CMPRBG454 ..Chev 427/454 66-90 2-pc. seal, 4.250"-4.310" Bore..	\$119.99
CMPRBG360 ..Dodge/Chrysler, 360, 71-88 4.000"-4.080" Bore.....	95.99
CMPRBG302F ..Ford 289-302 ,63-82, 4.000" - 4.080 "Bore.....	97.99
CMPRBG302L ..Ford 302 /5.0L, 82-85,4.000" - 4.080 "Bore.....	97.99
CMPRBG351W ..Ford 351W ,77-87, 4.000" - 4.080 "Bore.....	99.99
CMPRBG351L ..Ford 351W/5.8L ,88-91, 4.000" - 4.080 "Bore.....	107.99

King Performance Rod & Main Bearings Hastings Piston Rings Complete Gasket set



WAS NOW

Rotating Assembly. CPXSR383D- BAL, SBC, Eagle 383, 3.75S 4340 crank, 6.0" H Beam Rods, Howards 2618 13.1 forged pistons ,4.030 bore, Plasma Moly rings, Clevite H bearings , Int. Balanced.....	2300.00	1800.00
Eagle Rot. Assy....CPXEAGB13470030, SBC,400, Int.Bal..cast 3.75 crank, hyper. 4.155 pistons ,SIR 5.7 rods, 10.8 CR. Moly rings,King bearings.....	929.00	829.00
Rev Limiter.....CPXETPE3-1441.....TWO Step, E Racing.....	88.99	68.99

Discontinued Rockers

CPX6279R... SB FORD...Steel Long Slots. 7/16 Stud, Roller Tip, 1.70,Ratio, With Slotted Balls and Nuts. Blem, Light Rust on Rocker Tips. Regular..\$ 129.95 Set.....NOW **\$29.95 Set**



383 SB Chev SHORT BLOCKSCPXSB383-FF

Assembled and blueprinted , INT. balanced, Stroker Clearanced.

- NEW 4-bolt main, priority main oiling,
- siamese block,
- w/cam bearings & freeze plugs
- Eagle 4340 forged crank
- Howards Track Smart 4340 H-Beam rods
- Icon forged F/T. 11-1 CR W 64 CC
- Howards plasma moly rings
- King HP bearings

LIMITED QUANTITIES!
.\$4,295.00
Extra Freight Applies

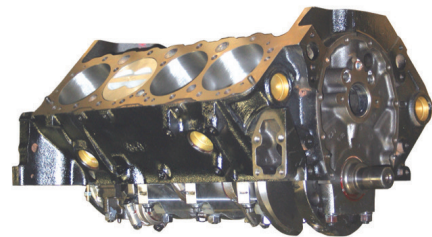

S

Screw-In Studs..CPX3973416 SB Chev 3/8 Hi-Perf Set , non-collared.....	29.00	20.00
Spark Plug Wires CPXMOR73614..Moroso Ultra 40 race set, 8.65 mm, straight boots sleeved.....	235.99	186.00
Spark Plug Wires CPXMOR72521..Moroso Blue Max, 8 mm., 90 degree, SBC8.65 mm, straight boots sleeved.....	95.99	72.99
Spark Plug Wires CPXMSD31223...8.5 mm, 90 degree boot, universal MSD.....	132.97	109.00
Spark Plug Wires CPXMOR9764N..Moroso Magtune 8.0 mm., straight, BBC.....	109.99	89.95
Spark Plug Wires CPXMOR9225M..Moroso Magtune , 72-84 Corvette, HEI.....	37.99	22.99
Spark Plug Wires CPXMOR73617..Moroso Ultra 40 race, 8.65 mm., 90 degree boots. long sleeved.....	235.99	186.00
Stud Girdle ..CPXHRC90121 BB Chev 7/16 for Dart Pro, Brodix, AFR, World, 24 degree, has scratch, KIT.....	279.95	219.95
Stud Kit Mains CPXARP140- 5402, ARP, 2 bolt main., 12 pt. Mopar V-8.....	79.97	58.99

T

Throttle Body.....CPXPFP69733...Prof.Products, GM, LS2, 101mm.....	255.95	189.95
Timing Chain.....CPX3354324..Replacement roller chain, Chev BB racing, true roller, Dyna gear.....	23.95	7.95
Timing Chain.....CPX3354208 Pontiac True roller chain, racing Quality, Dyna gear.....	29.00	7.95
Timing Cover.....CPXPVT58425 BB Chev , Gen 5, Aluminum	39.95	29.95
Tach.....VDOA2C59517134 VDO, 10,000 RPM, 5" Electric.....	126.99	89.99
Transmission Shield...CPXTWPS07 Ford C6, SFi, 6061-T6,TWRCP.....	142.99	119.95
Transmission Shield...CPXTWPS12 GM, TH700R4, SFi, 6061-T6, TWRCP.....	195.99	149.95

V

Valve.....CPXSiV6002SG-S,PONTIAC 400/428 SI, Intake, 1.960 x 5.082, comp series set	127.60	89.95
Valve Lock Tool Kit....CPXCCA5308, Comp Cams Pro, remove / install tool, 7mm, 8mm, 5/16 locks.....	49.95	39.95



Stainless Steel Performance Valve Sets

We continually beat up valve manufacturers on large quantities of valves. When they compete with each other to increase their sales, we pass the savings on to you. These are the same valves that other people are selling, but up to 65% less! These valves are manufactured of high grade 21-4N stainless steel material. Quality one-piece forgings. Valve stems are hard chromed and micro polished for an exceptional finish and to reduce wear. Fully machined combustion faces. Hardened tips to resist valve stem wear.

- One piece Forgings
- 21-4N Stainless steel
- Chrome stems
- Fully machined & polished
- Hardened tips
- Great quality



Valve Special!

Chev SB 11/32" stem

PVT8430...(8)1.940 int.&(8)1.500 exh.

PVT8435...(8)1.940 int.& (8)1.600 exh.

PVT8445...(8)2.020 int.& (8)1.500 exh.

PVT8440...(8)2.020 int.& (8)1.600 exh.

\$ 99.95 - SET OF 16

PVT8441...(8)2.020+100 & (8)1.600exh.

\$ 107.95 - SET OF 16

Chev BB 3/8" stem

PVT8455...(8)2.065 int.&(8)1.720 exh.

PVT8456...(8)2.190 int.& (8)1.720exh.

PVT8450...(8)2.190 int. & (8)1.880 exh.

\$ 109.95- SET OF 16

Special Set Pricing! from **\$99.95** Set of 16!



V

... Unbeatable Deal ...

**Chev SB
Hydraulic/Mechanical Flat Tappet Kits**
With 10° Retainer & Valve Locks
For OE, Dart Iron Eagle S/S & 180, Engine Quest Vortec,
World S/R & S/R Torquer Heads

Each Complete Kit Includes:

- 16 Stainless Steel Valves, One piece, Chrome Stem, Hardened Tip
- 16 Performance Hydraulic/Mechanical Flat tappet Valve Springs
110 @ 1.800", 340 @ 1.150", 1.160" Coil Bind, .570" Max Lift
- 16 Steel 10° Valve Spring Retainers
- 32 Forged Steel 10° Valve Locks
- 16 VTO Ultimate Duty Valve Seals



CMP851295Kit, w/1.94"-1.50" Valves, Hyd./Mech. FT to .570" Lift.....	\$149.95
CMP851296Kit, w/1.94"-1.60" Valves, Hyd./Mech. FT to .570" Lift.....	\$149.95
CMP851225Kit, w/2.02"-1.50" Valves, Hyd./Mech. FT to .570" Lift.....	\$149.95
CMP851226Kit, w/2.02"-1.60" Valves, Hyd./Mech. FT to .570" Lift.....	\$149.95

Kits Available with +.100" Valves, Call for details

Valve Cover..... CPXPVT56255..BB Chev tall, 3-3/4" without breather hole, polished fab alum.....	99.95	79.95
Valve Cover..... CPXPVT56355..Ford 429-460, tall, without breather hole, fab alum. long bolt.....	89.95	79.99
Valve Cover..... CPXPVT59205..SB Chev, steel, black,.....	29.95	19.99
Valve Cover..... CPXPVT56262..BB Chev, Fab. aluminum. slight warp.....	112.99	79.95
Valve Cover.....CPXPVT56243..BB Chev, Fab. aluminum, small dent	115.95	84.95
Valve Locks.....CPXCRO8611X-16 , 8mm , 7 degree, LS-1+.050.....	89.95	54.99
Valve Locks.....CPX4135	VTO, Forged Steel 7 Degree Valve Locks, 3/8 Valve Stem, Set of 16 Pair..Was 14.95, now	5.82 (10 sets 1.95 ea.)
Valve Locks.....CPX4438	VTO, Forged Steel 10 Degree Valve Lock, 3/8 Valve Stem.....	Was 17.95, now 4.95 (10 sets 2.95 ea.)
Valve SealsHRC93321.....	VTO Ultimate PC, 3/8 for .531, nitro, alcohol tolerant,.....	Set of 16 3/8..... \$18.99. 8.99
Valve SealsHRC93320-100.....	VTO Ultimate PC, 3/8 for .531, nitro, alcohol tolerant,.....	Pack of 100 pcs. (\$22.60 or \$3.62 /set)
Valve Seal Tool.....CPX7042.....	.PC. Installation Tool	4.60 .99

W

Water Temp. Gauge..CPXAUT2355.....	Autometer 100-280 degree electric, autogauge.....	46.99	34.99
Wire Loom.....CPXMRG9753.....	Each has 4-dividers, tall, chrome, pair.....	5.95	1.97
Wire Separator...CPXMRG9750.....	Chrome, 7 & 8 mm, 2-wire, short, pair.....	5.95	1.97
Wire Separator...CPXMRG9751.....	Chrome , 7 & 8 mm, 4-wire, pair.....	5.95	1.97
Wire Separator...CPXMRG9752.....	Chrome, 7 & 8 mm, 2-wire, tall, pair.....	5.75	1.87
Wrist Pins..... CPXHRC92258	Tool Steel .927" x 2.500" 115-145", Tapered wall, 118 grams.....	Set. of 8	168.00 89.00
Wrist Pins..... CPXHRC92298....	Tool Steel .927" x 2.950" 125-180", Tapered wall, 143 grams,.....	Set. of 8	168.00 89.00
Wrist Pins..... CPXELGP1019	H-11Tool Steel .990"O.D. .090 wall, 2.930" APR 96 Grams ,	EACH 1/2 off.....	19.98 ea.. 9.99
Wrist Pins..... CPXELGP1264.....	1018 cold rolled Steel .927"O.D. .150 wall, 2.950" APR 141 Grams ,	EACH 1/2 off.....	9.99 ea.. 4.99
Wrist Pins..... CPXELGP1284	H-11Tool Steel .912"O.D. .090 wall, 2.500" APR 74.5 Grams ,	EACH 1/2 off.....	16.99 ea.. 8.99
Wrist Pins..... CPXELG1995.....	H-11Tool Steel .990"O.D. .130 wall, 2.930" APR 130 Grams	EACH 20% off ..	19.98 ea. 15.99

T-SHIRT SUPER DEALS For Our Broom Sheet Guys!

CMPS003-2X...2-xtra.large.....\$4.99



WHILE SUPPLY LASTS!
CMPS003-XL...xtra.large.....\$4.99





ENFORCER HEADS

NEW ITEMS!



Enforcer HEADS ...Fully assembled, PAC springs, Viton seals, hardened seats , machined locks, 21-4-N stainless valves

- SB CHEV** ARP rocker studs, adj. guide plates, to .600 lift, hydraulic roller
 AFR 1001, 195/64 cc, straight plug, 2.05, 1.6,\$1187 00 pair
 AFR 1006, 195/64 cc, angle plug, 2.05, 1.6,\$1187 00 pair
- LS-1** Cathedral port, 210/64cc, AFR 1501,hydraulic roller.....\$1316 00 pair
- BB CHEV** AFR 3001 ARP studs, PAC hydraulic roller springs, 325/122 cc
 2.25/1.88 valves.....\$1727.16 pair
- FORD** AFR 1351 289-351W, ARP studs, Adj. guide plqates, PAC hydraulic roller
 springs, to .600 lift,185/64cc, stud mount, \$1198.00 pair



STAINLESS STEEL ROLLER ROCKERS

Features extra large full needle bearing trunnions designed to increase horsepower, provide quicker response,increase durability and allow high RPM stability with no deflection. The large roller tip provides less friction and a smooth path over the valve tip which reduces wear on the valve to rocker contact area.Sets of 16. Posi-locks included.

- ELGSSR840RS.....Chev SB, 3/8"1.5 ratio.....\$179.95
- ELGSSR840SPRS..Chev SB, 3/8"1.6 ratio.....\$179.95
- ELGSSR1840RS...Chev SB, 7/16"1.5 ratio.....\$185.95
- ELGSSR840SPRS..Chev SB, 7/16"1.6 ratio.....\$185.95
- ELGS868RS.....Chev BB, 7/16"1.7 ratio.....\$179.95
- ELGSSR756RS..Chry SB,(stud mount) 3/8"1.65 ratio.....\$185.95
- ELGSSR2889RS..Ford, SB,(stud mount) , 3/8"1.6 ratio.....\$179.95
- ELGSSR889RS..Ford, SB,(stud mount) , 7/16"1.6 ratio.....\$179.95
- ELGSSR888SPRS..Ford,429-460, 7/16"1.7ratio.....\$179.95
- ELGSSR846RS.Pontiac V-8, 7/16"1.5 ratio.....\$179.95
- ELGSSR848RS.Pontiac V-8, 7/16"1.65 ratio.....\$182.95.

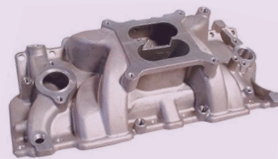

DUAL PLANE INTAKES

OutstandingStreet & Street-Strip performance. Designed for optimal fuel atomization and power range of 1000-6000 rpm. Designed for square bore 4150/4160 carbs and includes dual distributor holddowns.

- PVT29-7106.....Chev SB, satin.....\$169.95
- PVT29-7107.....Chev SB,vortec'96-latersatin..\$169.95
- PVT29-7109.....Ford 260-302,, satin.....\$169.95



ASSEMBLED WIRE SETS



- MOR9075M Chev SB/BB w/HEI,135 degree spark plug.....\$42.37
- MOR9072M Chev SB/BB w/HEI,straight spark plug.....\$39.34
- MOR9637M Chev LS02-12 ,4.8,5.3,6.0,6.2L spark plug.....\$36.99
- MOR9051M Chrys./Dodge 318-360 w/socket cap.....\$32.99
- MOR9075M Buick, Olds, Pontiac w/HEI, 135 degree spark plug.....\$42.37
- MOR9359M Ford 302, 351W, 460, 77-83 w/HEI cap.....\$39.99
- UNIVERSAL WIRE SETS**
- MOR9703M HEI ,90 degree spark plug.....\$32.99
- MOR9701M HEI ,straight spark plug.....\$36.99

DUAL PLANE INTAKE MANIFOLD KITS

Premium intake gaskets, Carburetor gasket, 12 point intake bolt set, Carburetor stud kit, All-in-one RTV silicone sealer.

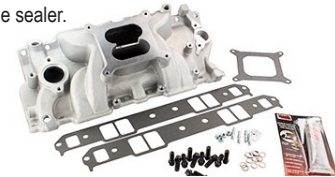

- PVT29-7106K.....Chev SB, satin.....\$195.95
- PVT29-7107K.....Chev SB,vortec'96-later, satin.....\$206.95
- PVT29-7109K.....Ford 260-302,, satin.....\$195.95



BILLET READY-TO-RUN DISTRIBUTORS

State of the art circuitry design for use with or without an external ignition control, like a CDI box. Perfect for street/street-strip or other applications that a vacuum advance is desired. For strength & reliability, they are constructed with a CNC machined billet aluminum body & hardened shaft.with a sealed ball bearing on top & a sintered steel bushing on bottom.High output magnetic pickup for accuracy, adjustable mechanical & vacuum advance. Includes 3-wire hookup & dielectric cap w/brass terminals/rotor.

- PVT25-3001.....Chev SB/BB, w/red cap.....\$169.99
- PVT25-3002.....Chev SB/BB, w/blackcap.....\$169.99
- PVT25-3021.....Chev SB/BB, w/slip collar,red cap.....\$189.99
- PVT25-5001.....Chrysler SB, w/red cap.....\$179.99
- PVT25-5201**.....Chrysler 383, 400 w/red cap.....\$179.99
- PVT25-5301**.....Chrysler 413,426,440 w/red cap.....\$179.99
- PVT25-4001.....Ford 351C/M,429-460 w/red cap.....\$175.99
- PVT25-4002.....Ford 280-302, 400 w/black cap.....\$175.99
- PVT25-4101.....Ford 351W, w/red cap.....\$175.99
- PVT25-4102.....Ford 351W, w/black cap.....\$175.99
- PVT25-4201.....Ford 351C/M,429-460 w/red cap.....\$179.99
- PVT25-4301.....Ford FE 332-428 w/red cap.....\$179.99
- PVT25-7001.....Oldsmobile V-8 w/red cap.....\$179.99
- PVT25-6001.....Pontiac V-8 w/red cap.....\$179.99

**Will not fit with fabricated valve covers

**1/2 OFF!
OR MORE**

BRAND NEW RETURNS!

All Sales Final!

	WAS	NOW
ASSEMBLY LUBE CPX2800-B5 Clevite bearing guard , 1-1/3 oz. , enough for one engine.....		\$1.00
BEARINGSCPXMS829P-STD STD. Clevite, BBC mains STD open , minor scuffing.....	89.95	44.95
BEARINGSCPXACL5M429H STD. ACL race, SBC , S/J mains, minor scuffing.....	89.95	55.99
CAM BEARING TOOL ...CPXPVT106820 ,Remove, install cam bearings, most any engine.....	119.95.	59.95
ELECTRIC WATER PUMPCPXPVT26-1254 , SB Ford /setup, chrome, damaged gasket.....	159.95	119.95
ENGINE MOUNTS CPXPVT27-MM500, SB Chev, steel , display V-8.....	39.95	20.99
PISTONSCPXSEA H345CP-40 350 Chev., + .040, F/T, 4 VR. 9.25-164cc, 7 pcs.....		75.00
PUSHRODSCPXHRC95122-8-11450 , Howards Moly , .080 W, 11.450L, 3/8, 8 pcs.....	103.92	46.25
PUSHRODSCPXHRC95499-8-9700, Howards one piece, 9.700" , .080, 3/8, 8 pieces.....	119.92	54.95
PUSHRODSCPXHRC95499-8-9900, Howards one piece, 9.900" , .080, 3/8, 8 pieces.....	119.92	54.95
PUSHRODSCPXMRP516-9500 BC Manton chrome moly, 9.38OL, OAL 9.500 cup, ball, 5/16, 8 pcs.....	90.00	40.00
RADIATORPXNTH209659B, Alum. universal race, 22" x 21.5" , test fit,	359.95	195.00
TIMING COVER CPXPVT58425, BBC Gen 5, installed, Power Products, polished aluminum.....	42.95	21.50
TORQUE CONVERTER ..CPXBMM70420 BM Torq master 2000, GM TH 700-R4, 30 spline. V-8 installed.....	364.95	182.95
VALVE COVERS ..CPXPVT56262 fabricated alum., polished, BBC tall, slight warp.....	112.99	56.99
VALVE LOCKSCPXCRO86118X1-16 Crower, 8 mm, 7 degree LSI Bead lock.....	89.95	54.99



NEW ULTIMATE DUTY BELT DRIVES

The Ultimate Camshaft Drive for your competition engine. Manufactured from the finest materials on state of the art CNC machining centers. These belt drives will deliver reduced valve train harmonics, precise valve timing and longer valve spring life. A fully rollerized thrust housing means less friction. A full 20" of Valve timing adjustment.

**Simple valve timing adjustments in minutes
Quick and easy cam changes**

HRC94900...Chev SB.....	\$1349.95
HRC94908...Chev LS.....	\$1649.95
HRC94905...Chev BB.....	\$1349.95
HRC94942..Dodge/ChryslerBB raised cam..	\$1659.95
HRC94925..Ford FE 390-427.....	\$1659.95

FREE!

POWER PRODUCTS OIL FILTER CUTTER

PVT10-6649 A \$39.99 Value with any SBC or BBC
KEVCO Drag Oil Pan



280 W. 35th Avenue
 Oshkosh, Wisconsin
 54902-7173

PRSR STD
 US POSTAGE
PAID
 UMS

SUPER DEALS- All Sales Final!

Toll Free Ordering
1.800.233.0199



**All Sales
 Final**
**Not Liable
 for Misprints**

www.competitionproducts.com